



Mobilized Data Collection, Processes & Automated Reporting for

AUTOMATED DEBRIS MANAGEMENT (ADM)

Mobile Epiphany provides **Touch Mobile ADM**, an application for Automated Debris Management (ADM) that mobilizes data collection, automates processes and generates reports for jurisdictional monitoring of debris operations. **Touch Mobile ADM** is a comprehensive solution that helps jurisdictions and monitoring companies increase visibility in each step of the processes, streamline accurate collection of data, conform to FEMA 325 processes and prevent fraud in every step of the process.

The software runs on almost any of today's modern smart devices, including cell phones and tablets running Apple, Android, Blackberry or Windows PC operating systems. **Touch Mobile ADM** incorporates all of FEMA's documented best practices to guide the user through a step-by-step approach for recording all data. Each user, based on their login credentials and role, can only see the forms and data specific to their particular task.

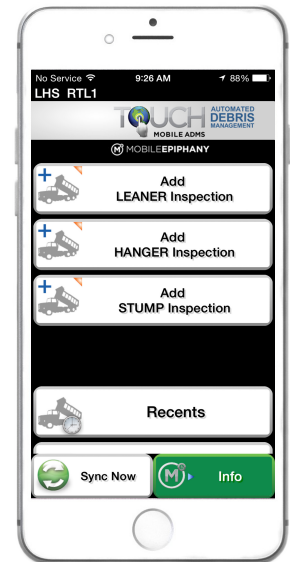

Roles include (but are not limited to):

Client Admin	Can review all collected data
Debris Removal Prime Contractor Admin	Can review all contractor data, including pre-certified trucks and crew members
Field Monitor	Monitors trucks as they leave a worksite, providing haul tickets
Leaners, Hangers, & Stumps Recon	Scouts an area for eligible leaning or hanging trees/branches and tree stumps
Leaners, Hangers, & Stumps Recon Admin	Administrator of leaners, hangers, and stumps recon teams
Leaners, Hangers, & Stumps Removal	Documents the removal of eligible leaners, hangers, and stumps
Monitoring Company Admin	Reviews crew and zone assignments of monitoring sub-contractors
Sector Supervisors	Issues truck safety violations, crew member safety, behavioral and property damage violations
Tower Monitor	Monitors trucks entering a dump, accepts haul tickets
Truck Certifier	Measures volume capacity of trucks and certifies them for work



Contact us today to obtain a login ID to test a full version of our application.

877.318.7215
WWW.MOBILEEPIPHANY.COM





Supervisor level users have the ability to quickly view data coming in from across the field. The reporting engine allows administrators to request reports from a PC, a web browser or directly from their mobile device. Any custom report you may wish to see can be created and shared across the entire organization.

Touch Mobile ADM Benefits:

- Designed in conjunction with Debris Removal subject matter experts to ensure the quick collection of data needed based on FEMA’s processes and forms
- Easy data collection and reporting for: Contractor Information Acquisition, Truck Certifications, LHS Recon Team Creation, LHS Recon and Haul Tracking, LHS Calculations, Supervisor Data Management, Haul Ticketing and Fraud Prevention
- Security and distribution of data for reconciliation and invoicing
- Automatically tally and generate all daily haul ticket volumes for internal use and contractors
- Configure, deploy and make additional modifications quickly and as required

Touch Mobile ADM Features:

- Highly intuitive and user-friendly, even to users unfamiliar with smart devices and the required processes
- The application works online or offline – network connectivity is not required for full use in the field
- Capture photos and signatures with GPS, date and time stamps. Draw directly on photos if required
- Role based security and permissions for field users and back office administrators – users only see data relevant to their role
- Work Crumbing® technology ensures that all data captured is recorded with date, time and GPS location for event tracking and worker productivity analysis
- Runs on a variety of mobile devices including iPhone, iPad (iOS), Android, Windows PC and Blackberry devices

TOUCH AUTOMATED DEBRIS MANAGEMENT
MOBILE ADMS



Our Touch Mobile ADM solution was created in conjunction with Debris Removal Experts and conforms to all of FEMA’s processes.

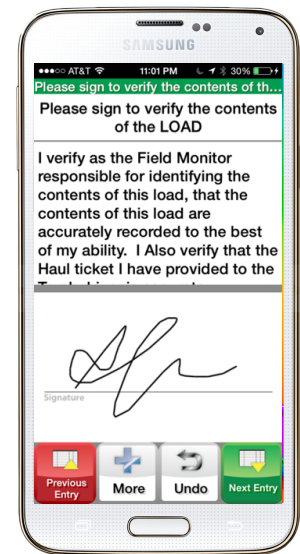

Contact us today to obtain a login ID to test a full version of our application.

877.318.7215
WWW.MOBILEEPIPHANY.COM

