

Reclamation with Corrective Actions

20E--Sila 21-2: Reclamation



Project Details

Client	Industrial Resources Ltd.	Program Type	Reclamation (w/ Corrective Actions)
Program Number	20E-	Location	Sila 21-2
Project Description	Reclamation	Unique Project ID	20E--Sila 21-2
Project Start Date	9/4/2020	Project End Date	12/31/2020
Scheduled Date	9/9/2020	Due Date	11/30/2020
Project Owner	Jesse Smith	Project Manager	Henry McConnel
Field Supervisor	Ryan Franco		

[01] Arrival & Land Uses

Type of Site	Single Well	Describe Other Site Type	
Location Land Use(s)	Other Land Uses	Describe Other Land Use	Currently is used as an equipment storage area
Land Utilization	Commercial	Describe Other Land Utilization	
Access Restrictions Present?	False	Access Restrictions	
Gate Access Code		Other Access Restriction	
Public or Private Land	Private Land	Was the Land Owner Contacted?	True
Notable Odors?	False	Odor Description	False
Overhead Powerlines?	True		

Reclamation with Corrective Actions

20E--Sila 21-2: Reclamation



[02] Crop

Sweet Clover

Is the Crop Observed On-Site or Off-Site?	On-Site	Crop	Sweet Clover
Observed by User	Ryan Franco	Date/Time Observed	9/9/2020 5:41:47 PM
Percent (%) Coverage of Observed Crop	2	Was there a Previous Crop in the same Area?	No
Which GPS are you using to record the Observation?	My Device's GPS	Device's Internal GPS Latitude	XX.0691288056018
Device's Internal GPS Longitude	-XXX.938407865206		

Comments: Clover is growing along edge of the pad and on soil piles

Reclamation with Corrective Actions

20E--Sila 21-2: Reclamation



[02] Crop

Alfalfa

Is the Crop Observed On-Site or Off-Site?	On-Site	Crop	Alfalfa
Observed by User	Ryan Franco	Date/Time Observed	9/9/2020 5:45:07 PM
Percent (%) Coverage of Observed Crop	2	Was there a Previous Crop in the same Area?	No
Which GPS are you using to record the Observation?	My Device's GPS	Device's Internal GPS Latitude	XX.068545635027
Device's Internal GPS Longitude	-XXX.9382872312		

Comments: Alfalfa in between pad sites

Reclamation with Corrective Actions

20E--Sila 21-2: Reclamation



[11] Rocks, Trash, Equipment or Debris

Debris

Subsidence Observed On-Site or Off-Site?	On-Site	Rocks Trash Equipment Debris	Debris
Observed by User	Ryan Franco	Date/Time Observed	9/9/2020 6:14:49 PM
Which GPS are you using to record the Observation?	My Device's GPS	Device's Internal GPS Latitude	XX.0680834739893
Device's Internal GPS Longitude	-XXX.938216851664		

Comments: All things ranging from rock piles to usable equipment to mobile homes to debris from the old pad laying around

[14] Departure Form

Weed Coverage	20		Crop Coverage	1
Non-Crop Desirable Coverage	20		Bare Land Coverage	59
Project Completed?	Yes			
Departure Signature				

Reclamation with Corrective Actions

20E--Sila 21-2: Reclamation

Photo Log

[01] Arrival & Land Uses

Photo of Overhead Powerlines



Photo of the Site's Info Placard



Take a Photo of the Location Entrance Sign



Take a Photo of the Entry Gate's State of Security



Reclamation with Corrective Actions

20E--Sila 21-2: Reclamation



[02] Crop
Sweet Clover

Crop Photo - 1



Reclamation with Corrective Actions

20E--Sila 21-2: Reclamation



[02] Crop

Alfalfa

Crop Photo - 1



Crop Photo - 2



Reclamation with Corrective Actions

20E--Sila 21-2: Reclamation



[11] Rocks, Trash, Equipment or Debris

Debris

Rocks Trash Equipment Debris Photo - 1



Rocks Trash Equipment Debris Photo - 2



Rocks Trash Equipment Debris Photo - 3



Rocks Trash Equipment Debris Photo - 4



Reclamation with Corrective Actions

20E--Sila 21-2: Reclamation

[13] Site Sketch

Take a FOCUSED & FRAMED Photo of your Site Sketch

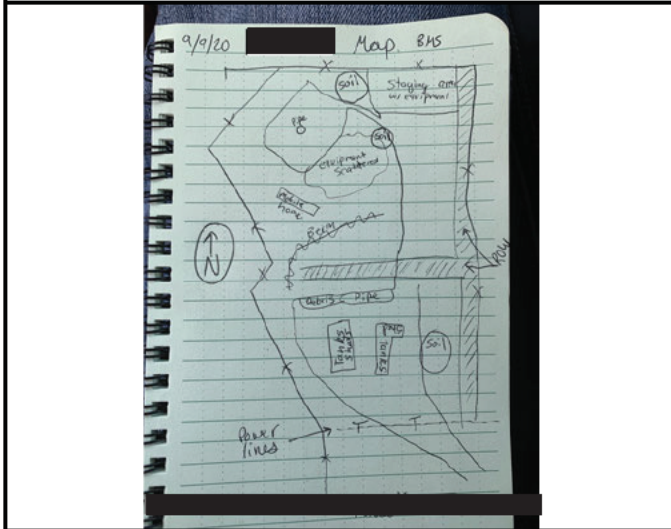

Reclamation with Corrective Actions



20E--Sila 21-2: Reclamation

[14] Departure Form

Weed Coverage Photo	Desirable Veg Photo
 <p>Location's Weed Coverage - Photo (1) Percentage: 20% Viewing Direction: North Date: 9/9/2020 7:22:18 PM Lat: 36.8045 Long: -93.7909</p>	 <p>Location's Non-Crop Desirable Vegetation Cover Percentage: 20% Viewing Direction: Northwest Desc: Grass on side of pad area/benms Date: 9/9/2020 7:22:18 PM Lat: 36.8045 Long: -93.7909</p>
 <p>Location's Bare Land Coverage - Photo (1) Percentage: 20% Viewing Direction: South Desc: Bare land Date: 9/9/2020 7:22:18 PM Lat: 36.8045 Long: -93.7909</p>	